

ROD SEALS

BECA 230/B



DESCRIPTION

The BECA 230/B profile is a rubber single acting rod seal with symmetrical lips and a second sealing lip. It can be assembled in a groove according to standard ISO 5597.

ADVANTAGES

Optimised sealing effect at both high and low pressures
 Excellent abrasion and wear resistance
 Assembly by deformation in closed groove

APPLICATIONS

Mobile hydraulics
 Injection presses
 Machine tools
 Presses
 Hydraulic cylinders

MATERIALS

PU 93 Shore A - Blue
 PU 96 Shore A - Blue
 High temp. PU 96 Shore A - Beige

Other grades of materials are available. Please contact our experts.

TECHNICAL DATA

Temperature	-30°C / +200°C
Pressure	15 MPa
Speed	0.5 m/sec
Media	Mineral hydraulic oils

The figures above indicate the maximum values and may not be cumulated. They may be developed, depending on the materials used.

EXTRUSION GAPS

Pressure MPa	Radial gap F/2
2.5 MPa	0.45
5.0 MPa	0.35
7.5 MPa	0.30
10.0 MPa	0.25
15.0 MPa	0.20

SURFACE ROUGHNESS

Roughness	Dynamic surface area	Static surface area	Groove flanks
Ra	0.1 - 0.4 µm	≤1.6 µm	≤3.2 µm
Rz	0.63 - 2.5 µm	≤6.3 µm	≤10.0 µm
Rmax	1.0 - 4.0 µm	≤10.0 µm	≤16.0 µm

CHAMFERS AND RADIUS

Radial section S	Radius R1	Radius R2	Chamfer C
3.50	0.20	0.40	2.00
5.00	0.40	0.60	2.50
7.50	0.80	1.00	4.00
10.00	0.80	1.00	5.00

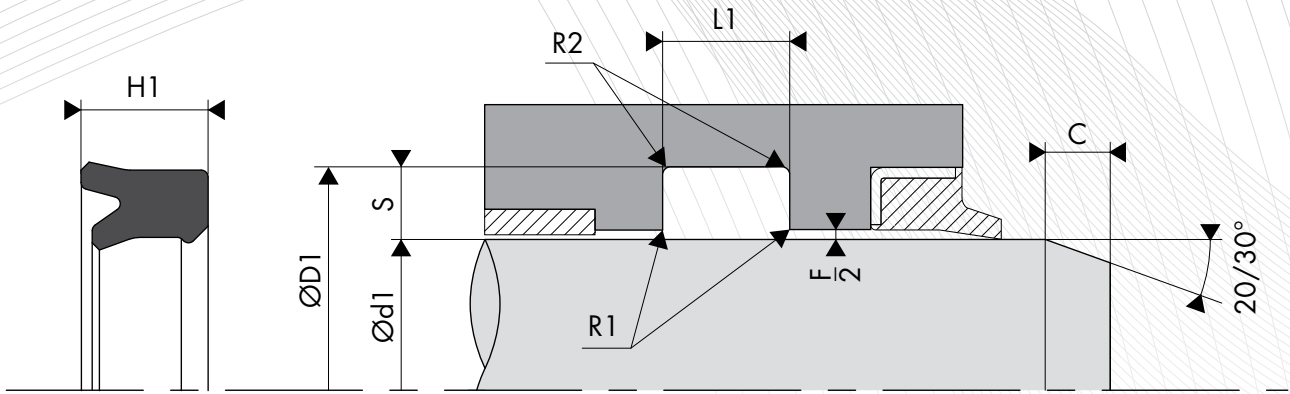

DIMENSIONS

Part number	Rod diameter Ød1 f8	Groove diameter ØD1 H10	Seal height H1	Groove width L1 0/+0.5
230.0121673	12.00	16.70	2.70	3.00
230.121673S	12.00	16.70	2.70	3.00
230.0141873	14.00	18.70	2.70	3.00
230.141873S	14.00	18.70	2.70	3.00
230.0151973	15.00	19.70	2.70	3.00
230.0162073	16.00	20.70	2.70	3.00
230.16203K8	16.00	20.70	2.70	3.00
230.162073S	16.00	20.70	2.70	3.00
230.0160226	16.00	22.00	5.50	6.00

Part number	Rod diameter Ød1 f8	Groove diameter ØD1 H10	Seal height H1	Groove width L1 0/+0.5
230.0202654	20.00	26.50	3.70	4.00
230.202654S	20.00	26.50	3.70	4.00
230.0232954	23.00	29.50	3.70	4.00
230.0283454	28.00	34.50	3.70	4.00
230.0300406	30.00	40.00	6.00	6.50
230.6030040	30.00	40.00	6.00	7.00
230.7030040	30.00	40.00	7.00	8.00
230.0450557	45.00	55.00	7.00	7.50
230.0891029	89.00	102.00	8.56	9.56

The figures highlighted in bold correspond to the dimensions for standard ISO 5597, with the rod diameters in line with standard ISO 3320. Other intermediate sizes can be provided.