

WIPER SEALS BECA 476

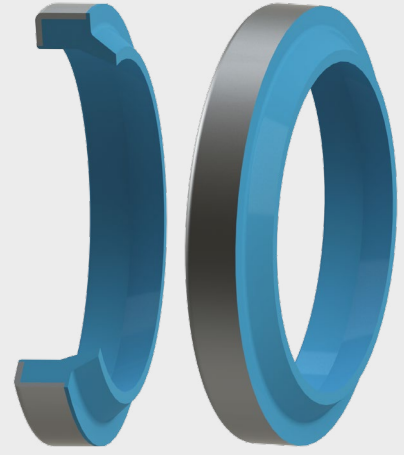

DESCRIPTION

The BECA 476 profile is a single acting wiper seal with a polyurethane metal insert.

ADVANTAGES

Tight and precise fitting in the housing
Very good external wiping effect
Excellent abrasion and wear resistance

APPLICATIONS

Agriculture
Mobile machinery
Material handling - Lifting
Hydraulic cylinders

MATERIALS

Profiled seal

PU 94 Shore A - White

Metal cage

Steel

Other grades of materials are available.
Please contact our experts.

TECHNICAL DATA

Temperature	-30°C / +110°C
Speed	1 m/s
Media	Mineral hydraulic oils

The figures above indicate the maximum values and may not be cumulated. They may be developed, depending on the materials used.

SURFACE ROUGHNESS

Roughness	Dynamic surface area	Static surface area	Groove flanks
Ra	0.1 - 0.4 µm	≤1.6 µm	≤3.2 µm
Rz	0.63 - 2.5 µm	≤6.3 µm	≤10.0 µm
Rmax	1.0 - 4.0 µm	≤10.0 µm	≤16.0 µm

CHAMFER

The chamfer length as well as the chamfer angle are determined by the rod seal.

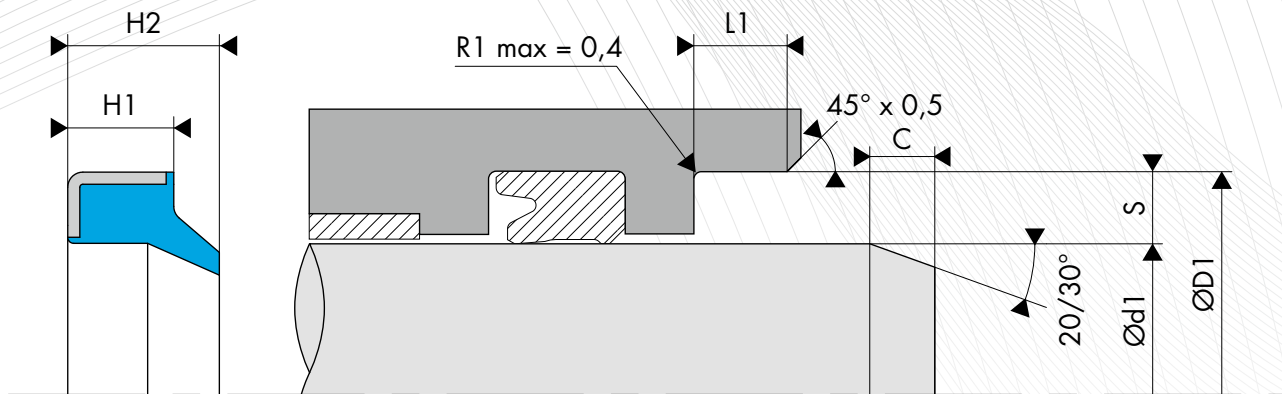

DIMENSIONS

Part number	Rod diameter Ød1 h9	Groove diameter ØD1 H8	Groove width L1 0/+0.20	Seal height H2
476.0130194	13.00	19.00	4.00	5.00
476.0140255	14.00	25.00	5.00	8.00
476.0200307	20.00	30.00	7.00	10.00
476.0250357	25.00	35.00	7.00	10.00
476.0280387	28.00	38.00	7.00	10.00
476.0300407	30.00	40.00	7.00	10.00
476.0350457	35.00	45.00	7.00	10.00
476.0400505	40.00	50.00	5.00	7.00
476.0400507	40.00	50.00	7.00	10.00
476.0450557	45.00	55.00	7.00	10.00
476.0500607	50.00	60.00	7.00	10.00
476.0550657	55.00	65.00	7.00	10.00
476.0550698	55.00	69.00	8.00	11.00
476.0560667	56.00	66.00	7.00	10.00
476.0570667	57.00	66.00	7.00	9.20
476.0600707	60.00	70.00	7.00	10.00
476.0600748	60.00	74.00	8.00	11.00
476.0630757	63.00	75.00	7.00	10.00

Part number	Rod diameter Ød1 h9	Groove diameter ØD1 H8	Groove width L1 0/+0.20	Seal height H2
476.0630778	63.00	77.00	8.00	11.00
476.0650757	65.00	75.00	7.00	10.00
476.0650798	65.00	79.00	8.00	11.00
476.0670767	67.00	76.00	7.00	9.20
476.0700807	70.00	80.00	7.00	10.00
476.0700848	70.00	84.00	8.00	11.00
476.0750898	75.00	89.00	8.00	11.00
476.0800907	80.00	90.00	7.00	10.00
476.0800948	80.00	94.00	8.00	11.00
476.0850998	85.00	99.00	8.00	11.00
476.0901007	90.00	100.00	7.00	10.00
476.0901048	90.00	104.00	8.00	11.00
476.0951098	95.00	109.00	8.00	11.00
476.1001107	100.00	110.00	7.00	10.00
476.1251409	125.00	140.00	9.00	12.00
476.1601759	160.00	175.00	9.00	12.00
476.1801951	180.00	195.00	10.00	14.00

The figures highlighted in bold correspond to the rod diameters that are recommended by standard ISO 3320. Other intermediate sizes can be provided.