

WIPER SEALS BECA 477

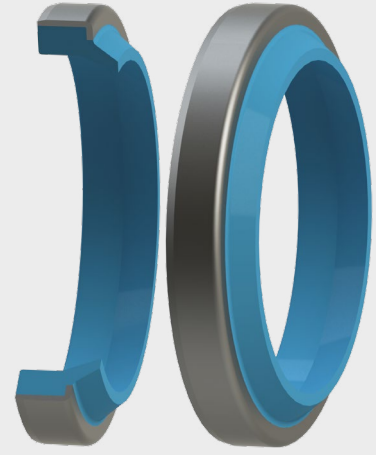

DESCRIPTION

The BECA 477 profile is a single acting wiper seal with a polyurethane metal insert.

ADVANTAGES

Tight and precise fitting in the housing
Very good external wiping effect
Excellent abrasion and wear resistance

APPLICATIONS

Agriculture
Mobile machinery
Material handling - Lifting
Hydraulic cylinders

MATERIALS

Profiled seal

PU 94 Shore A - White

Metal cage

Steel

Other grades of materials are available.
Please contact our experts.

TECHNICAL DATA

Temperature	-30°C / +110°C
Speed	1 m/s
Media	Mineral hydraulic oils

The figures above indicate the maximum values and may not be cumulated. They may be developed, depending on the materials used.

SURFACE ROUGHNESS

Roughness	Dynamic surface area	Static surface area	Groove flanks
Ra	0.1 - 0.4 µm	≤1.6 µm	≤3.2 µm
Rz	0.63 - 2.5 µm	≤6.3 µm	≤10.0 µm
Rmax	1.0 - 4.0 µm	≤10.0 µm	≤16.0 µm

CHAMFER

The chamfer length as well as the chamfer angle are determined by the rod seal.

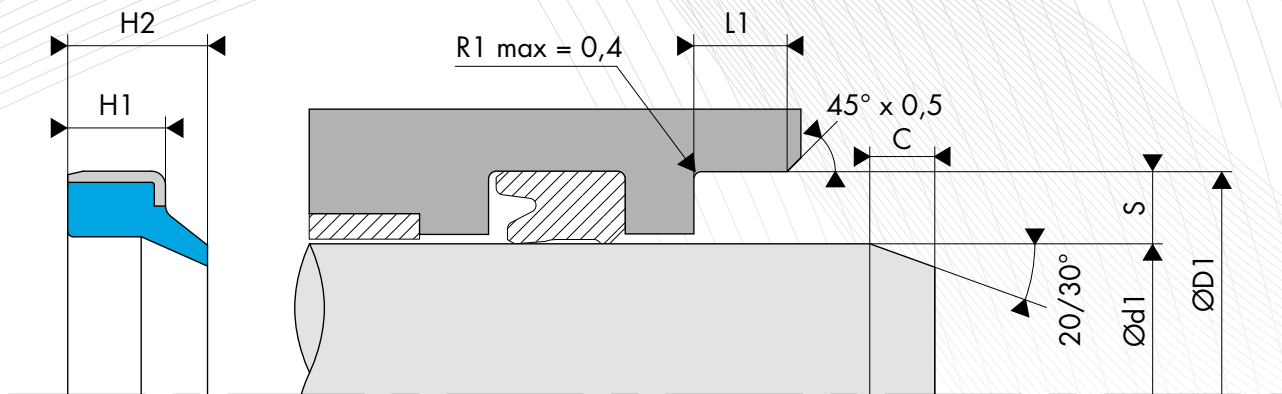

DIMENSIONS

Part number	Rod diameter Ød1 h9	Groove diameter ØD1 H8	Groove width L1 0/+0.20	Seal height H2
477.0100205	10.00	20.00	5.00	8.00
477.0120204	12.00	20.00	4.00	6.00
477.0150255	15.00	25.00	5.00	7.00
477.0160223	16.00	22.00	3.00	4.00
477.0160265	16.00	26.00	5.00	8.00
477.0170243	17.00	24.00	3.50	5.00
477.0180285	18.00	28.00	5.00	7.00
477.0180306	18.00	30.00	6.00	9.00
477.0200283	20.00	28.00	3.50	5.00
477.0200304	20.00	30.00	4.00	6.00
477.0200305	20.00	30.00	5.00	8.00
477.0250355	25.00	35.00	5.00	8.00
477.0250376	25.00	37.00	6.00	9.00
477.0280385	28.00	38.00	5.00	8.00
477.0280387	28.00	38.00	7.00	10.00
477.0300405	30.00	40.00	5.00	8.00
477.0300426	30.00	42.00	6.00	9.00
477.0300455	30.00	45.00	5.00	8.00
477.0320425	32.00	42.00	5.00	8.00
477.0320426	32.00	42.00	6.00	9.00
477.0320457	32.00	45.00	7.00	10.00
477.0320528	32.00	52.00	8.00	11.00
477.0350457	35.00	45.00	7.00	10.00
477.0350477	35.00	47.00	7.00	10.00
477.0400505	40.00	50.00	5.00	8.00
477.0400507	40.00	50.00	7.00	10.00
477.0400527	40.00	52.00	7.00	10.00
477.0400607	40.00	60.00	7.00	10.00
477.0450557	45.00	55.00	7.00	10.00
477.0450577	45.00	57.00	7.00	10.00
477.0450607	45.00	60.00	7.00	10.00
477.0500607	50.00	60.00	7.00	10.00
477.0500627	50.00	62.00	7.00	10.00

Part number	Rod diameter Ød1 h9	Groove diameter ØD1 H8	Groove width L1 0/+0.20	Seal height H2
477.0550655	55.00	65.00	5.00	8.00
477.0550657	55.00	65.00	7.00	10.00
477.0550698	55.00	69.00	8.00	11.00
477.0600707	60.00	70.00	7.00	10.00
477.0600745	60.00	74.00	5.00	8.00
477.0600748	60.00	74.00	8.00	11.00
477.0630757	63.00	75.00	7.00	10.00
477.0650757	65.00	75.00	7.00	10.00
477.0650798	65.00	79.00	8.00	11.00
477.0700807	70.00	80.00	7.00	10.00
477.0700848	70.00	84.00	8.00	11.00
477.0750857	75.00	85.00	7.00	10.00
477.0750898	75.00	89.00	8.00	11.00
477.0800907	80.00	90.00	7.00	10.00
477.0800948	80.00	94.00	8.00	11.00
477.0850957	85.00	95.00	7.00	10.00
477.0850998	85.00	99.00	8.00	11.00
477.0901007	90.00	100.00	7.00	10.00
477.0901048	90.00	104.00	8.00	11.00
477.0951057	95.00	105.00	7.00	10.00
477.0951098	95.00	109.00	8.00	11.00
477.1001107	100.00	110.00	7.00	10.00
477.1001148	100.00	114.00	8.00	11.00
477.1051219	105.00	121.00	9.00	12.00
477.1101207	110.00	120.00	7.00	10.00
477.1101269	110.00	126.00	9.00	12.00
477.1151319	115.00	131.00	9.00	12.00
477.1201307	120.00	130.00	7.00	10.00
477.1201369	120.00	136.00	9.00	12.00
477.1301469	130.00	146.00	9.00	12.00
477.1401601	140.00	160.00	10.00	14.00
477.1501701	150.00	170.00	10.00	14.00
477.1601801	160.00	180.00	10.00	14.00

The figures highlighted in bold correspond to the rod diameters that are recommended by standard ISO 3320. Other intermediate sizes can be provided.