

ROD SEALS

BECA 384

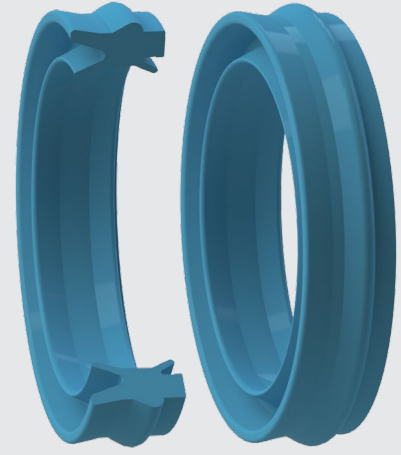

DESCRIPTION

The BECA 384 profile is a snap-on polyurethane monobloc rod seal.

ADVANTAGES

Excellent abrasion and wear resistance
Multi-functional sealing device and external wiper seal

APPLICATIONS

Shock absorbers
Distributor
Standard cylinders

MATERIALS

PU 93 Shore A - Blue
PU 96 Shore A - Blue
High temp. PU 96 Shore A - Beige

Other grades of materials are available.
Please contact our experts.

TECHNICAL DATA

Temperature	-30°C / +110°C
Pressure	1.6 MPa
Speed	1 m/s
Media	Lubricated air Oil-free air Non-aggressive gases

The figures above indicate the maximum values and may not be cumulated. They may be developed, depending on the materials used.

SURFACE ROUGHNESS

Roughness	Dynamic surface area	Static surface area	Groove flanks
Ra	0.1 - 0.4 µm	≤1.6 µm	≤3.2 µm
Rz	0.63 - 2.5 µm	≤6.3 µm	≤10.0 µm
Rmax	1.0 - 4.0 µm	≤10.0 µm	≤16.0 µm

CHAMFERS

Radial section S	Chamfer C
4.00	2.00
5.00	2.50

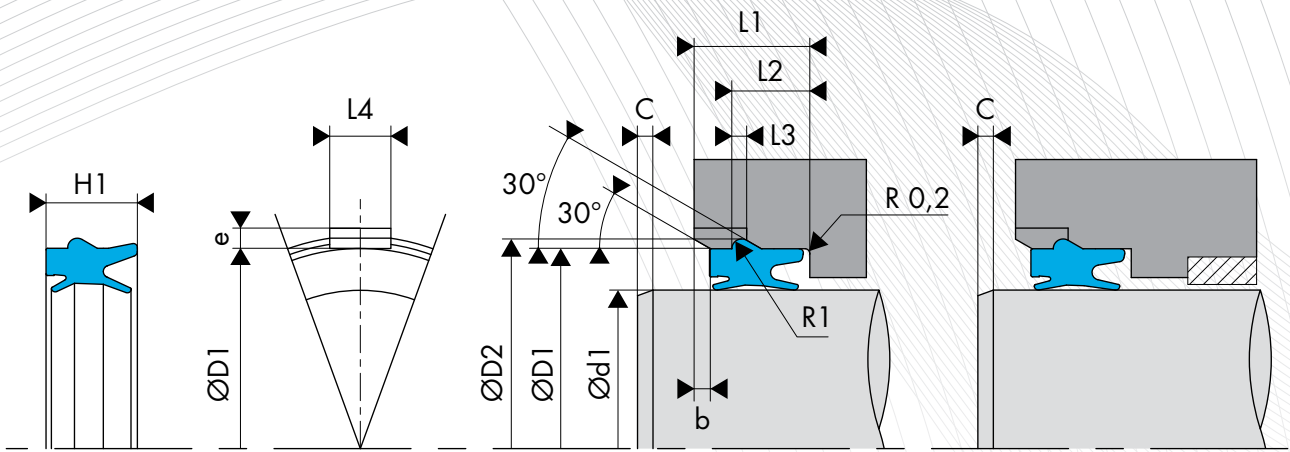

DIMENSIONS

Part number	Rod diameter Ød1 e9	Groove dimensions									
		ØD1 H10	ØD2 H10	H1	L1 0/+0.60	L2 0/+0.25	L3	L4	R 0/+0.20	e	b
384.0120201	12.00	20.00	22.00	10.70	13.00	8.80	2.20	4.00	1.10	1.80	1.50
384.0120221	12.00	22.00	24.00	10.70	13.00	8.80	2.20	4.00	1.10	1.80	1.50
384.0140241	14.00	24.00	26.00	10.70	13.00	8.80	2.20	4.00	1.10	1.80	1.50
384.0160261	16.00	26.00	28.00	10.70	13.00	8.80	2.20	5.00	1.10	1.80	1.50
384.0180261	18.00	26.00	28.00	10.70	13.00	8.80	2.20	5.00	1.10	1.80	1.50
384.0180281	18.00	28.00	30.00	10.70	13.00	8.80	2.20	5.00	1.10	1.80	1.50
384.0200301	20.00	30.00	32.00	10.70	13.00	8.80	2.20	5.00	1.10	1.80	1.50
384.0220321	22.00	32.00	34.50	11.20	14.00	9.40	2.80	7.50	1.40	2.00	2.00
384.0250351	25.00	35.00	37.50	11.20	14.00	9.40	2.80	7.50	1.40	2.00	2.00
384.0300401	30.00	40.00	42.50	11.20	14.00	9.40	2.80	7.50	1.40	2.00	2.00
384.0320421	32.00	42.00	44.50	11.20	14.00	9.40	2.80	7.50	1.40	2.00	2.00
384.0400501	40.00	50.00	52.50	11.20	14.00	9.40	2.80	7.50	1.40	2.00	2.00
384.0450551	45.00	55.00	58.20	12.20	15.00	10.40	3.60	10.00	1.80	2.50	2.00
384.0500601	50.00	60.00	63.20	12.20	15.00	10.40	3.60	10.00	1.80	2.50	2.00