

STATIC SEALS BECA 016

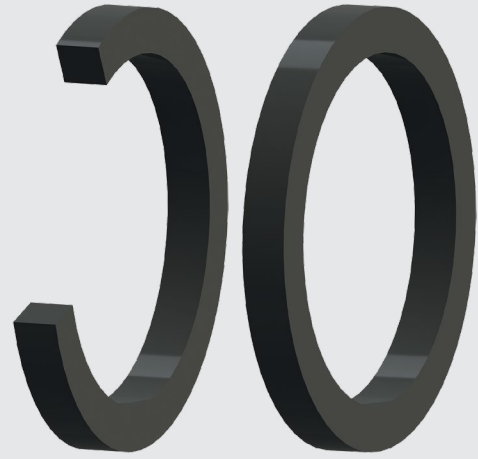

DESCRIPTION

The BECA 016 profile is a rubber square ring suitable for an axial static seal and is an alternative solution for O'Rings.

ADVANTAGES

- Good extrusion resistance, little sensitivity to extrusion gaps
- Good compression set
- No twisting in the seal
- No need for a connected back-up ring
- Limited mechanical deformation on the seal cross-section
- Long lifespan

APPLICATIONS

- Flanges
- Locks
- Valves

MATERIALS

- NBR 70 - 90 Shore A
- FKM 70 - 90 Shore A

Other grades of materials are available. Please contact our experts.

TECHNICAL DATA

Temperature	-30°C / +200°C
Pressure	54 MPa
Media	Mineral hydraulic oils Air Water Others (contact our experts)

The figures above indicate the maximum values and may not be cumulated. They may be developed, depending on the materials used.

SURFACE ROUGHNESS

On axial static applications	Ra μm	Rt μm	Rz μm
Contact surface area	$\leq 1.6 \mu\text{m}$	$\leq 10.0 \mu\text{m}$	$\leq 6.3 \mu\text{m}$
Groove diameter surface	$\leq 1.6 \mu\text{m}$	$\leq 16.0 \mu\text{m}$	$\leq 6.3 \mu\text{m}$
Groove flanks	$\leq 1.6 \mu\text{m}$	$\leq 16.0 \mu\text{m}$	$\leq 6.3 \mu\text{m}$
With pulsating pressures	Ra μm	Rt μm	Rz μm
Contact surface area	$\leq 0.8 \mu\text{m}$	$\leq 6.3 \mu\text{m}$	$\leq 6.3 \mu\text{m}$
Groove diameter surface	$\leq 1.6 \mu\text{m}$	$\leq 10.0 \mu\text{m}$	$\leq 6.3 \mu\text{m}$
Groove flanks	$\leq 1.6 \mu\text{m}$	$\leq 10.0 \mu\text{m}$	$\leq 6.3 \mu\text{m}$

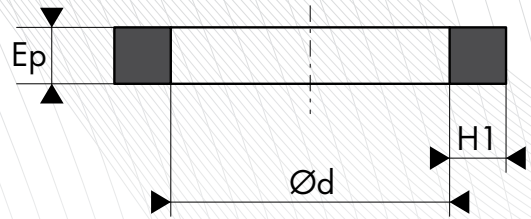
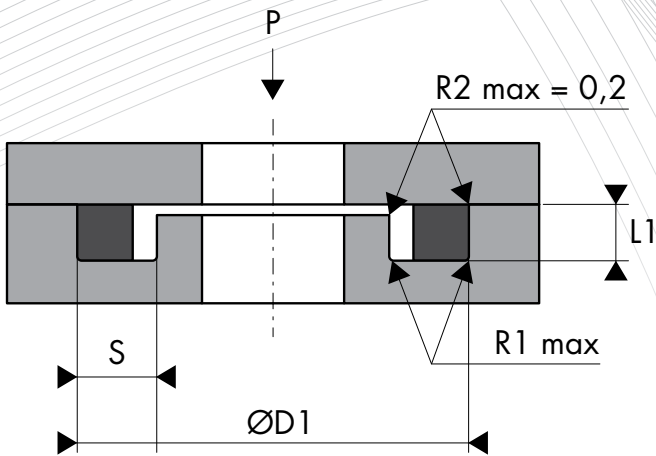

○ TOLERANCES ON THE INSIDE DIAMETER Ød OF THE SEAL

Inside diameter Ød	Tolerance
4.00 - 14.00	+/- 0.13
14.01 - 15.60	+/- 0.18
15.61 - 25.12	+/- 0.23
25.13 - 29.78	+/- 0.25
29.79 - 34.65	+/- 0.28
34.66 - 44.17	+/- 0.33
44.18 - 50.52	+/- 0.38
50.53 - 66.40	+/- 0.46
66.41 - 75.92	+/- 0.51
75.93 - 94.97	+/- 0.61
94.98 - 107.67	+/- 0.69
107.68 - 126.72	+/- 0.76
126.73 - 133.07	+/- 0.94
133.08 - 158.42	+/- 0.89
158.43 - 183.82	+/- 1.02
183.83 - 209.22	+/- 1.14
209.23 - 234.62	+/- 1.27
234.63 - 278.99	+/- 1.40
279.00 - 405.26	+/- 1.65
405.27 - 430.66	+/- 1.91
430.67 - 456.07	+/- 2.03

○ TOLERANCES ON THE THICKNESS Ep AND ON THE HEIGHT H1 OF THE SEAL

Seal height H1	Tolerance on H1	Seal thickness (Ep)	Tolerance on Ep
1.68	+/- 0.15	1.68	+/- 0.08
2.51	+/- 0.15	2.51	+/- 0.10
3.40	+/- 0.15	3.40	+/- 0.10
5.16	+/- 0.15	5.16	+/- 0.10
6.73	+/- 0.15	6.73	+/- 0.10

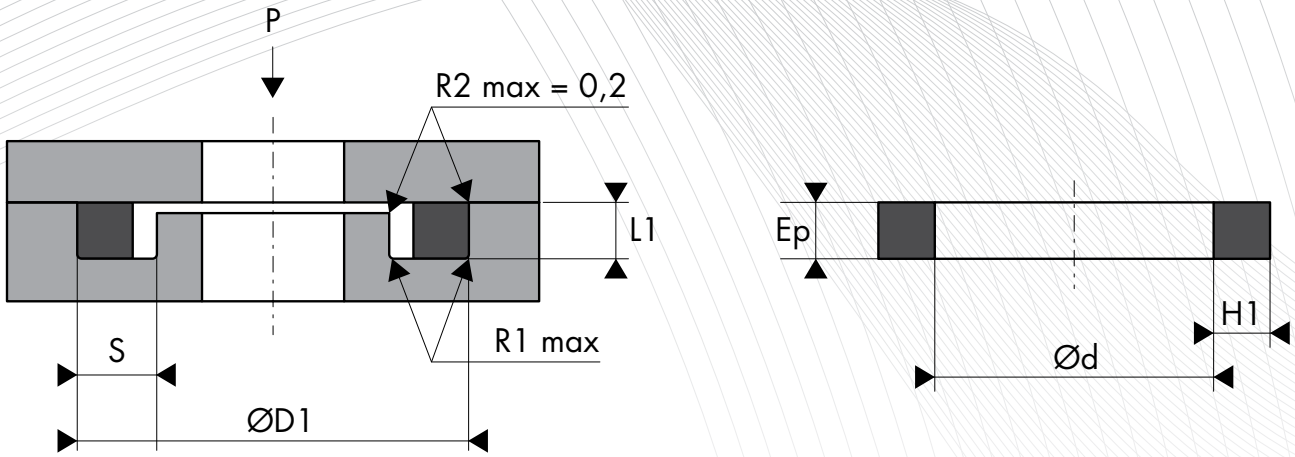

○ DIMENSIONS

Part number	Housing dimensions				Seal dimensions		
	Outside diameter ØD1 H11	Axial section S 0/+0.20	Width L1 -0.05/0	Radius R1 max	Inside diameter Ød	Seal height H1	Seal thickness Ep
016.00724	7.92	2.40	1.45	0.40	4.47	1.68	1.68
016.00824	8.71	2.40	1.45	0.40	5.28	1.68	1.68
016.00924	9.53	2.40	1.45	0.40	6.07	1.68	1.68
016.01124	11.10	2.40	1.45	0.40	7.65	1.68	1.68
016.01224	12.70	2.40	1.45	0.40	9.25	1.68	1.68
016.01424	14.27	2.40	1.45	0.40	10.82	1.68	1.68
016.01524	15.88	2.40	1.45	0.40	12.42	1.68	1.68
016.01724	17.45	2.40	1.45	0.40	14.00	1.68	1.68
016.01924	19.05	2.40	1.45	0.40	15.60	1.68	1.68
016.02024	20.62	2.40	1.45	0.40	17.17	1.68	1.68
016.02224	22.23	2.40	1.45	0.40	18.77	1.68	1.68
016.02324	23.80	2.40	1.45	0.40	20.35	1.68	1.68
016.02524	25.40	2.40	1.45	0.40	21.95	1.68	1.68
016.02624	26.97	2.40	1.45	0.40	23.52	1.68	1.68
016.02824	28.58	2.40	1.45	0.40	25.12	1.68	1.68
016.03024	30.15	2.40	1.45	0.40	26.70	1.68	1.68
016.03124	31.75	2.40	1.45	0.40	28.30	1.68	1.68
016.03324	33.32	2.40	1.45	0.40	29.87	1.68	1.68
016.03424	34.93	2.40	1.45	0.40	31.47	1.68	1.68
016.03624	36.50	2.40	1.45	0.40	33.05	1.68	1.68
016.03824	38.10	2.40	1.45	0.40	34.65	1.68	1.68
016.04124	41.28	2.40	1.45	0.40	37.82	1.68	1.68
016.04424	44.45	2.40	1.45	0.40	41.00	1.68	1.68
016.04724	47.63	2.40	1.45	0.40	44.17	1.68	1.68
016.05024	50.80	2.40	1.45	0.40	47.35	1.68	1.68
016.05324	53.98	2.40	1.45	0.40	50.52	1.68	1.68
016.05724	57.15	2.40	1.45	0.40	53.70	1.68	1.68
016.06024	60.33	2.40	1.45	0.40	56.87	1.68	1.68
016.06324	63.50	2.40	1.45	0.40	60.05	1.68	1.68
016.06624	66.68	2.40	1.45	0.40	63.22	1.68	1.68
016.06924	69.85	2.40	1.45	0.40	66.40	1.68	1.68
016.07324	73.03	2.40	1.45	0.40	69.57	1.68	1.68
016.07624	76.20	2.40	1.45	0.40	72.75	1.68	1.68
016.07924	79.38	2.40	1.45	0.40	75.92	1.68	1.68
016.08524	85.73	2.40	1.45	0.40	82.27	1.68	1.68
016.09224	92.08	2.40	1.45	0.40	88.62	1.68	1.68
016.09824	98.43	2.40	1.45	0.40	94.97	1.68	1.68
016.10724	107.95	2.40	1.45	0.40	101.32	1.68	1.68
016.11124	111.13	2.40	1.45	0.40	107.67	1.68	1.68
016.11724	117.48	2.40	1.45	0.40	114.02	1.68	1.68
016.12324	123.83	2.40	1.45	0.40	120.37	1.68	1.68
016.13024	130.18	2.40	1.45	0.40	126.72	1.68	1.68
016.13624	136.53	2.40	1.45	0.40	133.07	1.68	1.68

Part number	Housing dimensions				Seal dimensions		
	Outside diameter ØD1 H11	Axial section S 0/+0.20	Width L1 -0.05/0	Radius R1 max	Inside diameter Ød	Seal height H1	Seal thickness Ep
016.00936	9.53	3.60	2.30	0.40	4.42	2.51	2.51
016.01036	10.31	3.60	2.30	0.40	5.23	2.51	2.51
016.01136	11.10	3.60	2.30	0.40	6.02	2.51	2.51
016.01236	12.70	3.60	2.30	0.40	7.59	2.51	2.51
016.01436	14.27	3.60	2.30	0.40	9.19	2.51	2.51
016.01536	15.88	3.60	2.30	0.40	10.77	2.51	2.51
016.01736	17.45	3.60	2.30	0.40	12.37	2.51	2.51
016.01936	19.05	3.60	2.30	0.40	13.94	2.51	2.51
016.02036	20.62	3.60	2.30	0.40	15.54	2.51	2.51
016.02236	22.23	3.60	2.30	0.40	17.12	2.51	2.51
016.02336	23.80	3.60	2.30	0.40	18.72	2.51	2.51
016.02536	25.40	3.60	2.30	0.40	20.29	2.51	2.51
016.02636	26.97	3.60	2.30	0.40	21.89	2.51	2.51
016.02836	28.58	3.60	2.30	0.40	23.47	2.51	2.51
016.03036	30.15	3.60	2.30	0.40	25.07	2.51	2.51
016.03136	31.75	3.60	2.30	0.40	26.64	2.51	2.51
016.03336	33.32	3.60	2.30	0.40	28.24	2.51	2.51
016.03436	34.93	3.60	2.30	0.40	29.82	2.51	2.51
016.03636	36.50	3.60	2.30	0.40	31.42	2.51	2.51
016.03836	38.10	3.60	2.30	0.40	32.99	2.51	2.51
016.03936	39.67	3.60	2.30	0.40	34.59	2.51	2.51
016.04136	41.28	3.60	2.30	0.40	36.17	2.51	2.51
016.04236	42.85	3.60	2.30	0.40	37.77	2.51	2.51
016.04436	44.45	3.60	2.30	0.40	39.34	2.51	2.51
016.04636	46.02	3.60	2.30	0.40	40.94	2.51	2.51
016.04736	47.63	3.60	2.30	0.40	42.52	2.51	2.51
016.04936	49.20	3.60	2.30	0.40	44.12	2.51	2.51
016.05036	50.80	3.60	2.30	0.40	45.69	2.51	2.51
016.05236	52.37	3.60	2.30	0.40	47.29	2.51	2.51
016.05336	53.98	3.60	2.30	0.40	48.90	2.51	2.51
016.05536	55.55	3.60	2.30	0.40	50.47	2.51	2.51
016.05736	57.15	3.60	2.30	0.40	52.07	2.51	2.51
016.05836	58.72	3.60	2.30	0.40	53.64	2.51	2.51
016.06036	60.33	3.60	2.30	0.40	55.25	2.51	2.51
016.06136	61.90	3.60	2.30	0.40	56.82	2.51	2.51
016.06336	63.50	3.60	2.30	0.40	58.42	2.51	2.51
016.06536	65.07	3.60	2.30	0.40	60.00	2.51	2.51
016.06636	66.68	3.60	2.30	0.40	61.60	2.51	2.51
016.06836	68.25	3.60	2.30	0.40	63.17	2.51	2.51
016.06936	69.85	3.60	2.30	0.40	64.77	2.51	2.51
016.07136	71.42	3.60	2.30	0.40	66.34	2.51	2.51
016.07336	73.03	3.60	2.30	0.40	67.95	2.51	2.51
016.07436	74.60	3.60	2.30	0.40	69.52	2.51	2.51
016.07636	76.20	3.60	2.30	0.40	71.12	2.51	2.51
016.07736	77.77	3.60	2.30	0.40	72.69	2.51	2.51
016.08036	80.95	3.60	2.30	0.40	75.87	2.51	2.51
016.08736	87.30	3.60	2.30	0.40	82.22	2.51	2.51
016.09336	93.65	3.60	2.30	0.40	88.57	2.51	2.51
016.10036	100.00	3.60	2.30	0.40	94.92	2.51	2.51
016.10636	106.35	3.60	2.30	0.40	101.27	2.51	2.51
016.11236	112.70	3.60	2.30	0.40	107.62	2.51	2.51
016.11936	119.05	3.60	2.30	0.40	113.97	2.51	2.51
016.12536	125.40	3.60	2.30	0.40	120.32	2.51	2.51
016.13136	131.75	3.60	2.30	0.40	126.67	2.51	2.51
016.13836	138.10	3.60	2.30	0.40	133.02	2.51	2.51
016.14436	144.45	3.60	2.30	0.40	139.37	2.51	2.51
016.15036	150.80	3.60	2.30	0.40	145.72	2.51	2.51
016.15736	157.15	3.60	2.30	0.40	152.07	2.51	2.51
016.16336	163.50	3.60	2.30	0.40	158.42	2.51	2.51
016.16936	169.85	3.60	2.30	0.40	164.77	2.51	2.51
016.17636	176.20	3.60	2.30	0.40	171.12	2.51	2.51
016.18236	182.55	3.60	2.30	0.40	177.47	2.51	2.51

Part number	Housing dimensions				Seal dimensions		
	Outside diameter ØD1 H11	Axial section S 0/+0.20	Width L1 -0.05/0	Radius R1 max	Inside diameter Ød	Seal height H1	Seal thickness Ep
016.18836	188.90	3.60	2.30	0.40	183.82	2.51	2.51
016.19536	195.25	3.60	2.30	0.40	190.17	2.51	2.51
016.20136	201.60	3.60	2.30	0.40	196.52	2.51	2.51
016.20736	207.95	3.60	2.30	0.40	202.87	2.51	2.51
016.21436	214.30	3.60	2.30	0.40	209.22	2.51	2.51
016.22036	220.65	3.60	2.30	0.40	215.57	2.51	2.51
016.22736	227.00	3.60	2.30	0.40	221.92	2.51	2.51
016.23336	233.35	3.60	2.30	0.40	228.27	2.51	2.51
016.23936	239.70	3.60	2.00	0.40	234.62	2.51	2.51
016.24636	246.05	3.60	2.30	0.40	240.97	2.51	2.51
016.25236	252.40	3.60	2.30	0.40	247.32	2.51	2.51
016.01148	11.10	4.80	3.10	0.60	4.34	3.40	3.40
016.01248	12.70	4.80	3.10	0.60	5.94	3.40	3.40
016.01448	14.27	4.80	3.10	0.60	7.52	3.40	3.40
016.01548	15.88	4.80	3.10	0.60	9.12	3.40	3.40
016.01748	17.45	4.80	3.10	0.60	10.69	3.40	3.40
016.01948	19.05	4.80	3.10	0.60	12.29	3.40	3.40
016.02048	20.62	4.80	3.10	0.60	13.87	3.40	3.40
016.02248	22.23	4.80	3.10	0.60	15.47	3.40	3.40
016.02348	23.80	4.80	3.10	0.60	17.04	3.40	3.40
016.02548	25.40	4.80	3.10	0.60	18.64	3.40	3.40
016.02648	26.97	4.80	3.10	0.60	20.22	3.40	3.40
016.02848	28.58	4.80	3.10	0.60	21.82	3.40	3.40
016.03048	30.15	4.80	3.10	0.60	23.39	3.40	3.40
016.03148	31.75	4.80	3.10	0.60	24.99	3.40	3.40
016.03348	33.32	4.80	3.10	0.60	26.57	3.40	3.40
016.03448	34.93	4.80	3.10	0.60	28.17	3.40	3.40
016.03648	36.50	4.80	3.10	0.60	29.74	3.40	3.40
016.03848	38.10	4.80	3.10	0.60	31.34	3.40	3.40
016.03948	39.67	4.80	3.10	0.60	32.92	3.40	3.40
016.04148	41.28	4.80	3.10	0.60	34.52	3.40	3.40
016.04248	42.85	4.80	3.10	0.60	36.09	3.40	3.40
016.04448	44.45	4.80	3.10	0.60	37.69	3.40	3.40
016.04748	47.63	4.80	3.10	0.60	40.87	3.40	3.40
016.05048	50.80	4.80	3.10	0.60	44.04	3.40	3.40
016.05348	53.98	4.80	3.10	0.60	47.22	3.40	3.40
016.05748	57.15	4.80	3.10	0.60	50.39	3.40	3.40
016.06048	60.33	4.80	3.10	0.60	53.57	3.40	3.40
016.06348	63.50	4.80	3.10	0.60	56.74	3.40	3.40
016.06648	66.68	4.80	3.10	0.60	59.92	3.40	3.40
016.06948	69.85	4.80	3.10	0.60	63.09	3.40	3.40
016.07348	73.03	4.80	3.10	0.60	66.27	3.40	3.40
016.07648	76.20	4.80	3.10	0.60	69.44	3.40	3.40
016.07948	79.38	4.80	3.10	0.60	72.62	3.40	3.40
016.08248	82.55	4.80	3.10	0.60	75.79	3.40	3.40
016.08548	85.73	4.80	3.10	0.60	78.97	3.40	3.40
016.08848	88.90	4.80	3.10	0.60	82.14	3.40	3.40
016.09248	92.08	4.80	3.10	0.60	85.32	3.40	3.40
016.09548	95.25	4.80	3.10	0.60	88.49	3.40	3.40
016.09848	98.43	4.80	3.10	0.60	91.67	3.40	3.40
016.10148	101.60	4.80	3.10	0.60	94.84	3.40	3.40
016.10448	104.78	4.80	3.10	0.60	98.02	3.40	3.40
016.10748	107.95	4.80	3.10	0.60	101.19	3.40	3.40
016.11148	111.13	4.80	3.10	0.60	104.37	3.40	3.40
016.11448	114.30	4.80	3.10	0.60	107.54	3.40	3.40
016.11748	117.48	4.80	3.10	0.60	110.72	3.40	3.40
016.12048	120.65	4.80	3.10	0.60	113.89	3.40	3.40
016.12348	123.83	4.80	3.10	0.60	117.07	3.40	3.40
016.12748	127.00	4.80	3.10	0.60	120.24	3.40	3.40
016.13048	130.18	4.80	3.10	0.60	123.42	3.40	3.40
016.13348	133.35	4.80	3.10	0.60	126.59	3.40	3.40
016.13648	136.53	4.80	3.10	0.60	129.77	3.40	3.40

Part number	Housing dimensions				Seal dimensions		
	Outside diameter ØD1 H11	Axial section S 0/+0.20	Width L1 -0.05/0	Radius R1 max	Inside diameter Ød	Seal height H1	Seal thickness Ep
016.13948	139.70	4.80	3.10	0.60	132.94	3.40	3.40
016.14248	142.88	4.80	3.10	0.60	136.12	3.40	3.40
016.14648	146.05	4.80	3.10	0.60	139.29	3.40	3.40
016.14948	149.23	4.80	3.10	0.60	142.47	3.40	3.40
016.15348	153.40	4.80	3.10	0.60	145.64	3.40	3.40
016.15548	155.58	4.80	3.10	0.60	148.82	3.40	3.40
016.15848	158.75	4.80	3.10	0.60	151.99	3.40	3.40
016.16548	165.10	4.80	3.10	0.60	158.34	3.40	3.40
016.17148	171.45	4.80	3.10	0.60	164.69	3.40	3.40
016.17748	177.80	4.80	3.10	0.60	171.04	3.40	3.40
016.18448	184.15	4.80	3.10	0.60	177.39	3.40	3.40
016.19048	190.50	4.80	3.10	0.60	183.74	3.40	3.40
016.19648	196.85	4.80	3.10	0.60	190.09	3.40	3.40
016.20348	203.20	4.80	3.10	0.60	196.44	3.40	3.40
016.20948	209.55	4.80	3.10	0.60	202.79	3.40	3.40
016.21548	215.90	4.80	3.10	0.60	209.14	3.40	3.40
016.22248	222.25	4.80	3.10	0.60	215.49	3.40	3.40
016.22848	228.60	4.80	3.10	0.60	221.84	3.40	3.40
016.23448	234.95	4.80	3.10	0.60	228.19	3.40	3.40
016.24148	241.30	4.80	3.10	0.60	234.54	3.40	3.40
016.24748	247.65	4.80	3.10	0.60	240.89	3.40	3.40
016.25448	254.00	4.80	3.10	0.60	247.24	3.40	3.40
016.26048	260.35	4.80	3.10	0.60	253.59	3.40	3.40
016.27348	273.05	4.80	3.10	0.60	266.29	3.40	3.40
016.28548	285.75	4.80	3.10	0.60	278.99	3.40	3.40
016.29848	298.45	4.80	3.10	0.60	291.69	3.40	3.40
016.31148	311.15	4.80	3.10	0.60	304.39	3.40	3.40
016.33648	336.55	4.80	3.10	0.60	329.79	3.40	3.40
016.36148	361.95	4.80	3.10	0.60	355.19	3.40	3.40
016.38748	387.35	4.80	3.10	0.60	380.59	3.40	3.40
016.41248	412.75	4.80	3.10	0.60	405.26	3.40	3.40
016.43848	438.15	4.80	3.10	0.60	430.66	3.40	3.40
016.46348	463.55	4.80	3.00	0.60	456.06	3.40	3.40
016.02071	20.62	7.10	4.75	0.80	10.46	5.16	5.16
016.02271	22.23	7.10	4.75	0.80	12.07	5.16	5.16
016.02371	23.80	7.10	4.75	0.80	13.64	5.16	5.16
016.02571	25.40	7.10	4.75	0.80	15.24	5.16	5.16
016.02671	26.97	7.10	4.75	0.80	16.81	5.16	5.16
016.02871	28.58	7.10	4.75	0.80	18.42	5.16	5.16
016.03071	30.15	7.10	4.75	0.80	19.99	5.16	5.16
016.03171	31.75	7.10	4.75	0.80	21.59	5.16	5.16
016.03371	33.32	7.10	4.70	0.80	23.16	5.16	5.16
016.03471	34.93	7.10	4.75	0.80	24.77	5.16	5.16
016.03671	36.50	7.10	4.75	0.80	26.34	5.16	5.16
016.03871	38.10	7.10	4.75	0.80	27.94	5.16	5.16
016.03971	39.67	7.10	4.75	0.80	29.51	5.16	5.16
016.04171	41.28	7.10	4.75	0.80	31.12	5.16	5.16
016.04271	42.85	7.10	4.75	0.80	32.69	5.16	5.16
016.04471	44.45	7.10	4.75	0.80	34.29	5.16	5.16
016.04771	47.63	7.10	4.75	0.80	37.47	5.16	5.16
016.05071	50.80	7.10	4.75	0.80	40.64	5.16	5.16
016.05371	53.98	7.10	4.75	0.80	43.82	5.16	5.16
016.05771	57.15	7.10	4.75	0.80	46.99	5.16	5.16
016.06071	60.33	7.10	4.75	0.80	50.17	5.16	5.16
016.06371	63.50	7.10	4.75	0.80	53.34	5.16	5.16
016.06671	66.68	7.10	4.75	0.80	56.52	5.16	5.16
016.06971	69.85	7.10	4.75	0.80	59.69	5.16	5.16
016.07371	73.03	7.10	4.75	0.80	62.87	5.16	5.16
016.07671	76.20	7.10	4.75	0.80	66.04	5.16	5.16
016.07971	79.38	7.10	4.75	0.80	69.22	5.16	5.16
016.08271	82.55	7.10	4.75	0.80	72.39	5.16	5.16
016.08571	85.73	7.10	4.75	0.80	75.57	5.16	5.16

Part number	Housing dimensions				Seal dimensions		
	Outside diameter ØD1 H11	Axial section S 0/+0.20	Width L1 -0.05/0	Radius R1 max	Inside diameter Ød	Seal height H1	Seal thickness Ep
016.08871	88.90	7.10	4.75	0.80	78.74	5.16	5.16
016.09271	92.08	7.10	4.75	0.80	81.92	5.16	5.16
016.09571	95.25	7.10	4.75	0.80	85.09	5.16	5.16
016.09871	98.43	7.10	4.75	0.80	88.27	5.16	5.16
016.10171	101.60	7.10	4.75	0.80	91.44	5.16	5.16
016.10471	104.78	7.10	4.75	0.80	94.62	5.16	5.16
016.10771	107.95	7.10	4.75	0.80	97.79	5.16	5.16
016.11171	111.13	7.10	4.75	0.80	100.97	5.16	5.16
016.11471	114.30	7.10	4.75	0.80	104.14	5.16	5.16
016.11771	117.48	7.10	4.75	0.80	107.32	5.16	5.16
016.12071	120.65	7.10	4.75	0.80	110.49	5.16	5.16
016.12371	123.83	7.10	4.75	0.80	113.67	5.16	5.16
016.12771	127.00	7.10	4.75	0.80	116.84	5.16	5.16
016.13071	130.18	7.10	4.75	0.80	120.02	5.16	5.16
016.13371	133.35	7.10	4.75	0.80	123.19	5.16	5.16
016.13671	136.53	7.10	4.75	0.80	126.37	5.16	5.16
016.13971	139.70	7.10	4.75	0.80	129.54	5.16	5.16
016.14271	142.88	7.10	4.75	0.80	132.72	5.16	5.16
016.14671	146.05	7.10	4.75	0.80	135.89	5.16	5.16
016.14971	149.23	7.10	4.75	0.80	139.07	5.16	5.16
016.15271	152.40	7.10	4.75	0.80	142.24	5.16	5.16
016.15571	155.58	7.10	4.75	0.80	145.42	5.16	5.16
016.15871	158.75	7.10	4.75	0.80	148.59	5.16	5.16
016.16171	161.93	7.10	4.75	0.80	151.77	5.16	5.16
016.16871	168.28	7.10	4.75	0.80	158.12	5.16	5.16
016.17471	174.63	7.10	4.75	0.80	164.47	5.16	5.16
016.18071	180.98	7.10	4.75	0.80	170.82	5.16	5.16
016.18771	187.33	7.10	4.75	0.80	177.17	5.16	5.16
016.19371	193.68	7.10	4.75	0.80	183.52	5.16	5.16
016.20071	200.03	7.10	4.75	0.80	189.87	5.16	5.16
016.20671	206.38	7.10	4.75	0.80	196.22	5.16	5.16
016.21271	212.73	7.10	4.75	0.80	202.57	5.16	5.16
016.21971	219.08	7.10	4.75	0.80	208.92	5.16	5.16
016.22571	225.43	7.10	4.75	0.80	215.27	5.16	5.16
016.23171	231.78	7.10	4.75	0.80	221.62	5.16	5.16
016.23871	238.13	7.10	4.75	0.80	227.97	5.16	5.16
016.24471	244.48	7.10	4.75	0.80	234.32	5.16	5.16
016.25071	250.83	7.10	4.75	0.80	240.67	5.16	5.16
016.25771	257.18	7.10	4.75	0.80	247.02	5.16	5.16
016.26371	263.53	7.10	4.75	0.80	253.37	5.16	5.16
016.27671	276.23	7.10	4.75	0.80	266.07	5.16	5.16
016.28871	288.93	7.10	4.75	0.80	278.77	5.16	5.16
016.30171	301.63	7.10	4.75	0.80	291.47	5.16	5.16
016.31471	314.33	7.10	4.75	0.80	304.17	5.16	5.16
016.33971	339.73	7.10	4.75	0.80	329.57	5.16	5.16
016.36571	365.13	7.10	4.75	0.80	354.97	5.16	5.16
016.39071	390.53	7.10	4.75	0.80	380.37	5.16	5.16
016.41571	415.93	7.10	4.75	0.80	405.27	5.16	5.16
016.44171	441.33	7.10	4.75	0.80	430.67	5.16	5.16
016.46671	466.73	7.10	4.75	0.80	456.07	5.16	5.16
016.12795	127.00	9.50	6.10	0.80	113.67	6.73	6.73
016.13095	130.18	9.50	6.10	0.80	116.84	6.73	6.73
016.13395	133.35	9.50	6.10	0.80	120.02	6.73	6.73
016.13695	136.53	9.50	6.10	0.80	123.19	6.73	6.73
016.13995	139.70	9.50	6.10	0.80	126.37	6.73	6.73
016.14295	142.88	9.50	6.10	0.80	129.54	6.73	6.73
016.14695	146.05	9.50	6.10	0.80	132.72	6.73	6.73
016.14995	149.23	9.50	6.10	0.80	135.89	6.73	6.73
016.15295	152.40	9.50	6.10	0.80	139.07	6.73	6.73
016.15595	155.58	9.50	6.10	0.80	142.24	6.73	6.73
016.15895	158.75	9.50	6.10	0.80	145.42	6.73	6.73
016.16195	161.93	9.50	6.10	0.80	148.59	6.73	6.73

Part number	Housing dimensions				Seal dimensions		
	Outside diameter ØD1 H11	Axial section S 0/+0.20	Width L1 -0.05/0	Radius R1 max	Inside diameter Ød	Seal height H1	Seal thickness Ep
016.16595	165.10	9.50	6.10	0.80	151.77	6.73	6.73
016.17195	171.45	9.50	6.10	0.80	158.12	6.73	6.73
016.17795	177.80	9.50	6.10	0.80	164.47	6.73	6.73
016.18495	184.15	9.50	6.10	0.80	170.82	6.73	6.73
016.19095	190.50	9.50	6.10	0.80	177.17	6.73	6.73
016.19695	196.85	9.50	6.10	0.80	183.52	6.73	6.73
016.20395	203.20	9.50	6.10	0.80	189.87	6.73	6.73
016.20995	209.55	9.50	6.10	0.80	196.22	6.73	6.73
016.21595	215.90	9.50	6.10	0.80	202.57	6.73	6.73
016.22895	228.60	9.50	6.10	0.80	215.27	6.73	6.73
016.24195	241.30	9.50	6.10	0.80	227.97	6.73	6.73
016.25495	254.00	9.50	6.10	0.80	240.67	6.73	6.73
016.26695	266.70	9.50	6.10	0.80	253.37	6.73	6.73
016.27995	279.40	9.50	6.10	0.80	266.07	6.73	6.73
016.29295	292.10	9.50	6.10	0.80	278.77	6.73	6.73
016.30495	304.80	9.50	6.10	0.80	291.47	6.73	6.73
016.31795	317.50	9.50	6.10	0.80	304.17	6.73	6.73
016.33095	330.20	9.50	6.10	0.80	316.87	6.73	6.73
016.34295	342.90	9.50	6.10	0.80	329.57	6.73	6.73
016.35595	355.60	9.50	6.10	0.80	342.27	6.73	6.73
016.36895	368.30	9.50	6.10	0.80	354.97	6.73	6.73
016.38195	381.00	9.50	6.10	0.80	367.67	6.73	6.73
016.39395	393.70	9.50	6.10	0.80	380.37	6.73	6.73
016.40695	406.40	9.50	6.10	0.80	393.07	6.73	6.73
016.41995	419.10	9.50	6.10	0.80	405.27	6.73	6.73
016.43195	431.80	9.50	6.10	0.80	417.97	6.73	6.73
016.44495	444.50	9.50	6.10	0.80	430.67	6.73	6.73
016.45795	457.20	9.50	6.10	0.80	443.37	6.73	6.73
016.46995	469.90	9.50	6.10	0.80	456.07	6.73	6.73

Other intermediate sizes can be provided.